

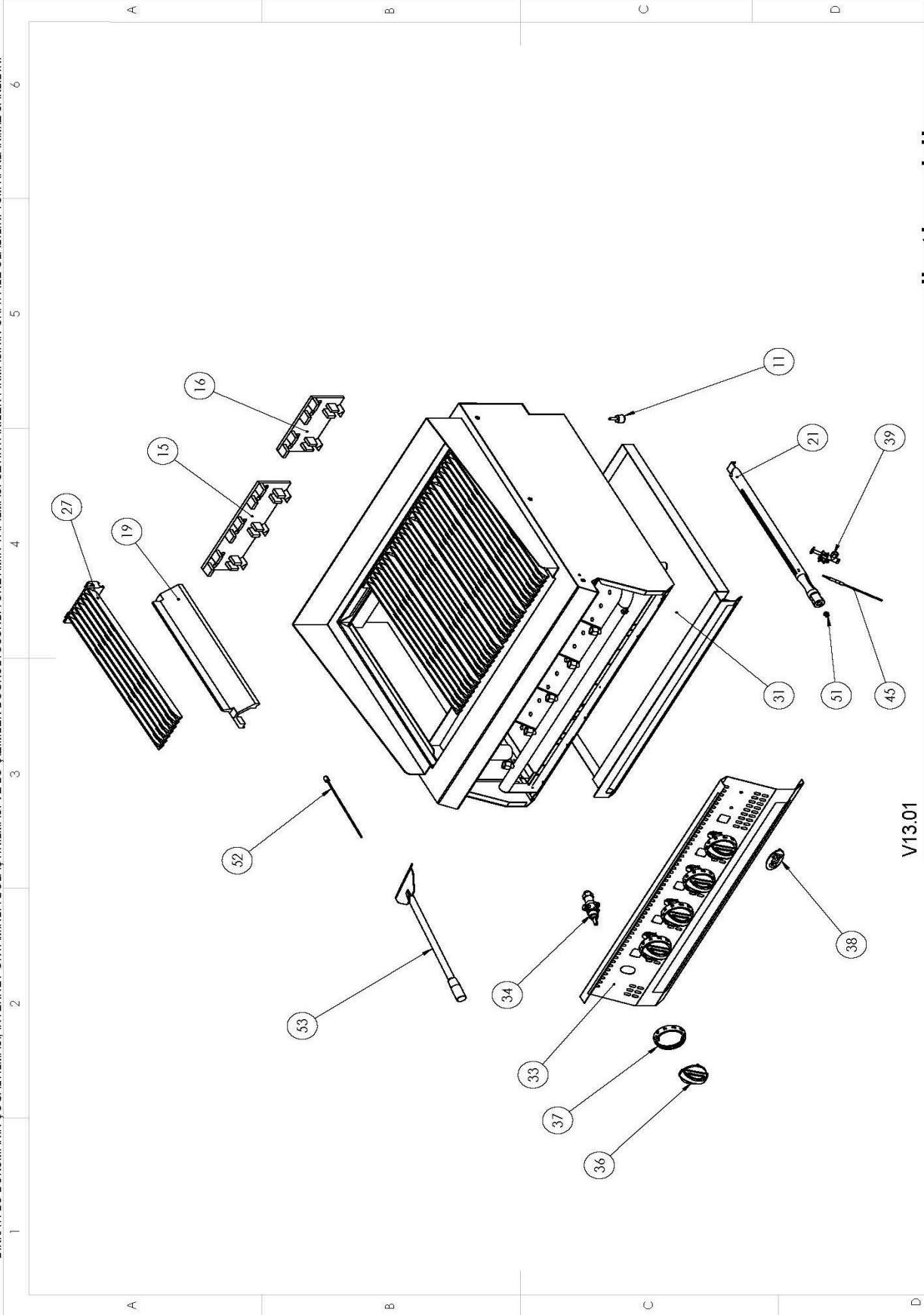

SPARE PART LIST

Spare Part ItemCode	Item name.	PictureId
6260.00002.05	ADJUSTABLE LEG M6	11
6260.00058.62	SUPPORT PART CAST IRON FOR BROILER REFLECTORS	15
6260.00058.64	REFLECTOR CAST IRON FOR 650-700 SERIES BROILER	19
6267.00002.043	BURNER TUBE S/S 650-700 SERIES BROILER	21
6260.00058.63	COOKING SURFACE CAST IRON FOR 650-700 SERIES BROILER	27
2864.N30.GR006.Y	80*70 DOKUM IZGARA YA DANLIK GRUBU	31
2864.N20.08000290.D.10	ODG 8090 ÖN PANEL SACI	33
9099.00A60.00	GAS VALVE MAX-MIN ADJUSTMENT PILOT OUTPUT WITH THERMOCOUPLE SAFE 21S	34
6260.00015.46	THERMOPLASTIC KNOB MAIN BODY WITH 8 mm INSERT	36
6260.00015.40	THERMOPLASTIC KNOB SCALE MAX.-MIN FLAME-LIGHTING	37
2179.09028.01	LABEL FOR FRONT PANEL "ÖZT RYAK LER"	38
6267.00023.08	PILOT ASSEMBLY 2 WAY FOR 700 SERIES GAS COOKER&WOK&BROILERS	39
6267.00024.09	THERMOCOUPLE M9x1 250 mm LENGTH	45
2KLP.460.626700006.05	MAIN BURNER NOZZLE M8x0,75 ANY GAS TYPE	51
2864.Q3028.99	EXTERNAL LIGHTING STICK FOR BROILERS	52
2864.Z20.00900080.D.60	EXTERNAL ACCESSORY CLEANING COMB FOR BROILERS	53

DİKKAT: BU DÖKÜMANIN COĞALTILMASI İNTERNET ORTAMINDA DOLAŞTIRILMASI VE BU ÇİZİMLER DOĞRULTUSUNDA ÜRETİMİN YAPILMASI ÖZTİRYAKİLER FİRMASININ ONAYI İLE OLABİLİR. TÜM HAKLARIMIZ SAKLIDIR.



V13.01

Öztiryakiler

ODG 8070

RİSD	BİİM	İMCA	TARİH	MATERİAL	TOLERANS
ÇİZEN	E.BASTUG		13.04.2012		DIN 7168
KONTROL	M.HACI		13.04.2012		ORTA
ONAY	M.HACI		13.04.2012		PARÇA ADI
					T. RESİM NO
					ODG 8070 patlamış

V13.01

RESİM ÜZERİNDEN ÖLÇÜ ALMAYINIZ! TÜM ÖLÇÜLER mm ÇİNSİNDİR. REVİZYON 1 ÖLÇEK ODG 8070 patlamış

WARNING: IT IS APPROPRIATE TO MULTIPLY, USE, DISPLAY AT COMPUTER/INTERNET AND PRODUCE THE PRODUCT WITH ITS DRAWINGS WITH THE APPROVAL OF ÖZTİRYAKİLER COMPANY. ALL RIGHTS RESERVED.